



LAMP

# JENGA

DESIGNER

LUO ZIYING  
WU ZHANGQUAN  
LI JIARONG  
LIN SHUYA

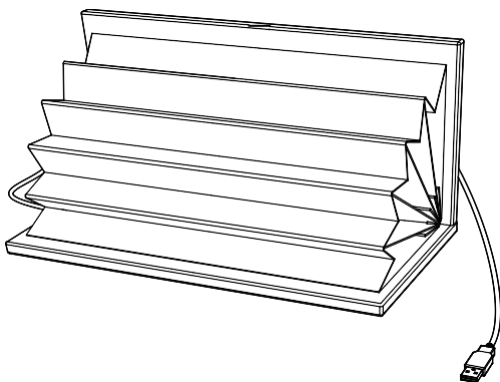

# MATERIALS



## Bamboo Boards

360\*182\*12mm\*2



## Bamboo Chips

340\*140\*2mm\*2

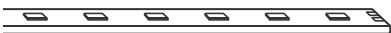

## LED Strip



## Cable

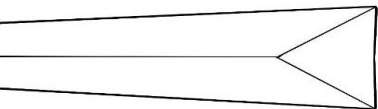

## Paper Bag

400\*260\*14mm

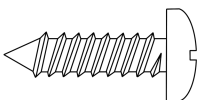

## Self-tapping screws

8mm\*4

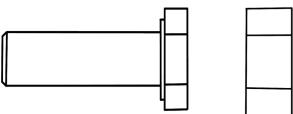

## Self-locking screws

16mm\*4

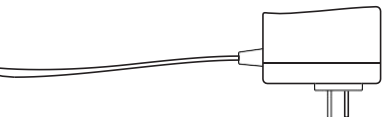

## Transformer

from 220V to 12V

# SIZE

A

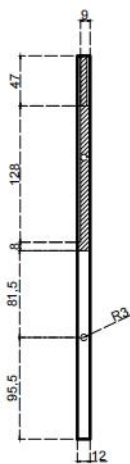
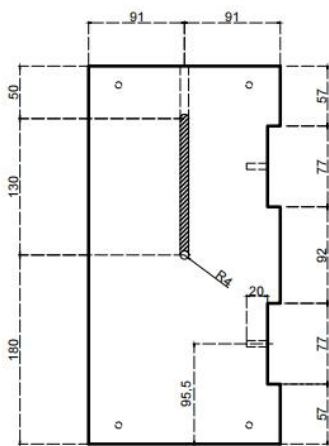

B

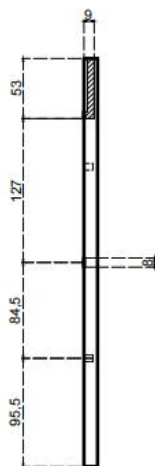
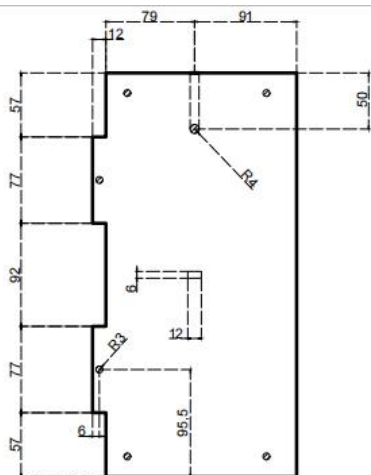

# SIZE

C

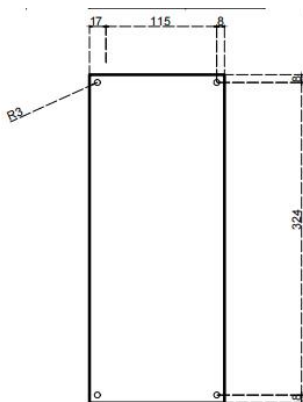

D

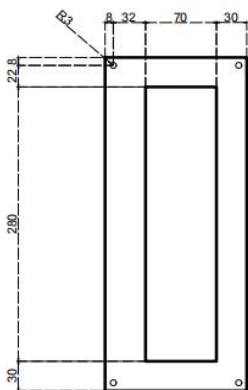

E

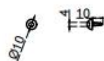
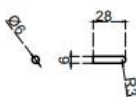

## STEP 1

Flod paper bag

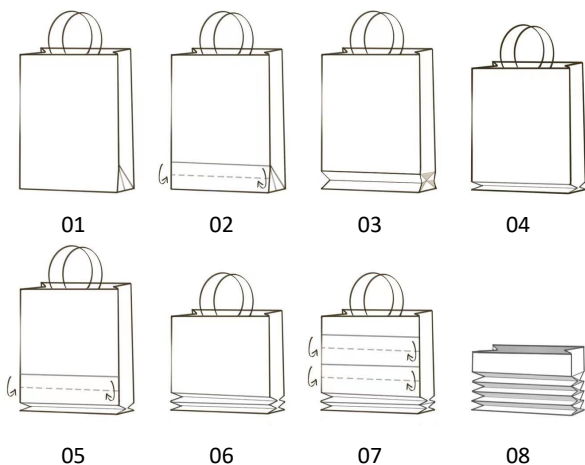

## STEP 2

Self-tapping screws

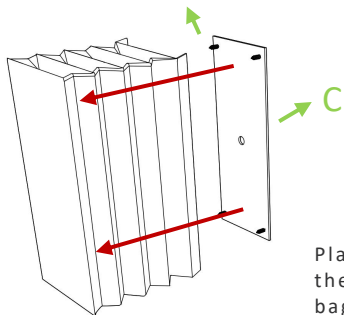

Place the bamboo chips at the bottom of the paper bag

## STEP 3

Fasten with self-locking screws

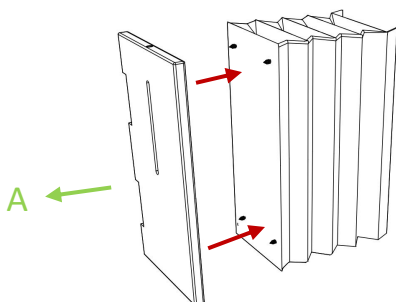

## STEP 4

Place the opening in the paper bag

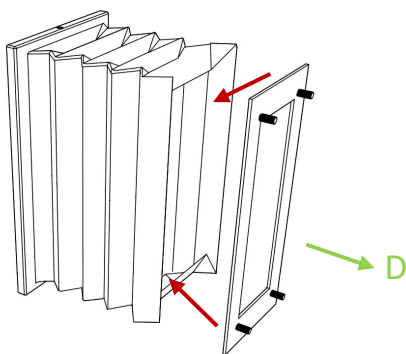

## STEP 5

Thread wires through them

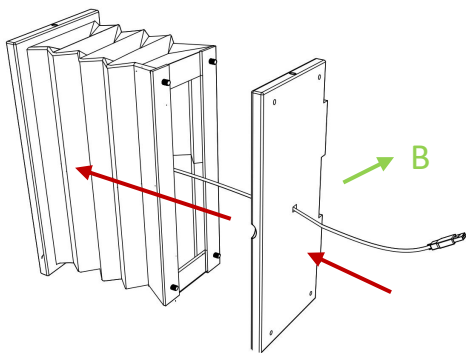

## STEP 6

Thread wires through them

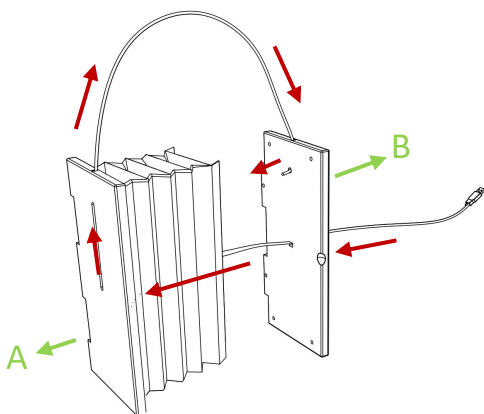

## STEP 7

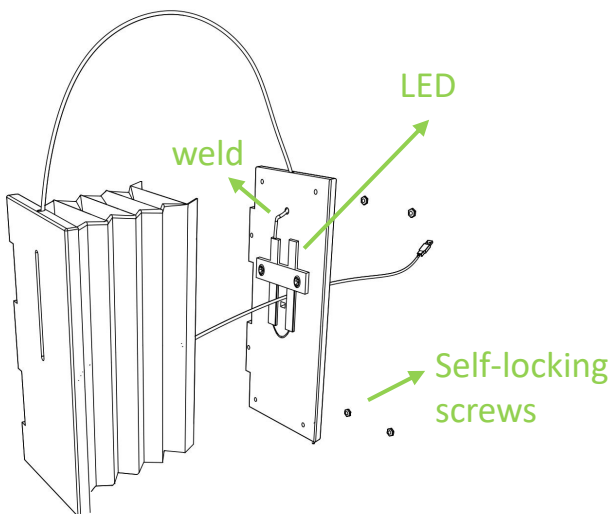

## STEP 8

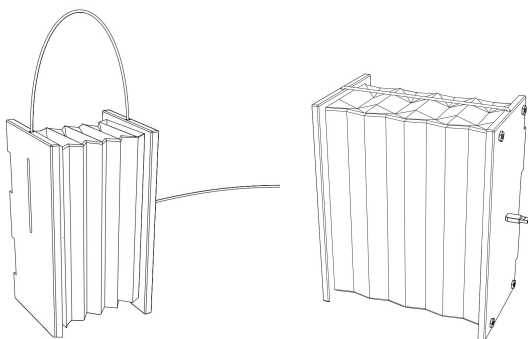



# Exploded view

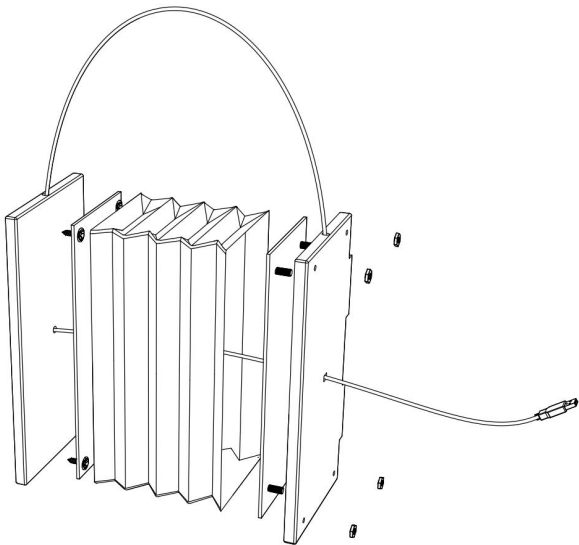

## view

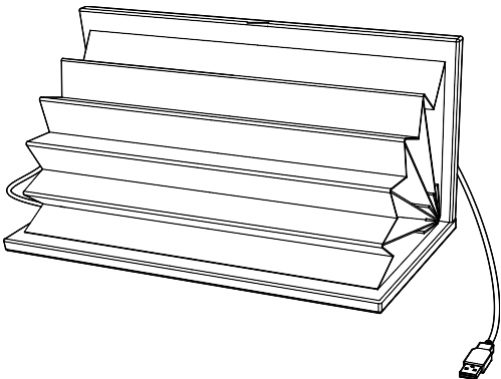

# CONGRATULATION!

Now you got your own lamp

If you meet some problems when building this lamp  
please contact us

[1677095995@qq.com](mailto:1677095995@qq.com)

[downloadopendesign@outlook.com](mailto:downloadopendesign@outlook.com)



OpenDesign