

Borja Stool

designer Li Chubing
Shen Huahui
Zhang Hong

materials 20mm Plybamboo board

tools Saw, Electrodrill, Screwdriver, Sandpaper

units mm

update 2019/5/13

Guangdong University of Technology
Opendedesign+DIY Workshop

*If you meet some problems when building this stool,
please contact us:782873946@qq.com

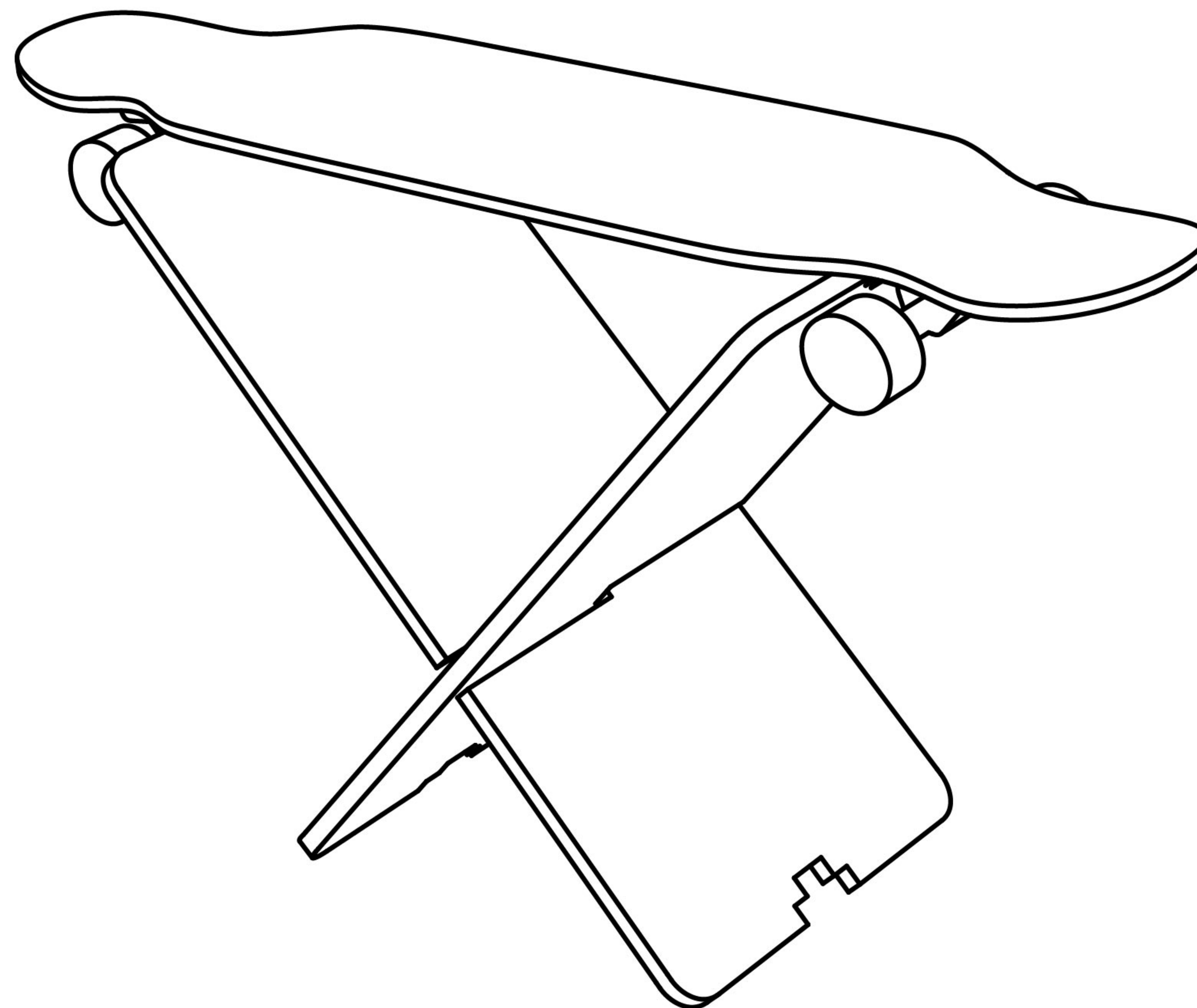

PARTS

20mm plybamboo boards

A (x2)

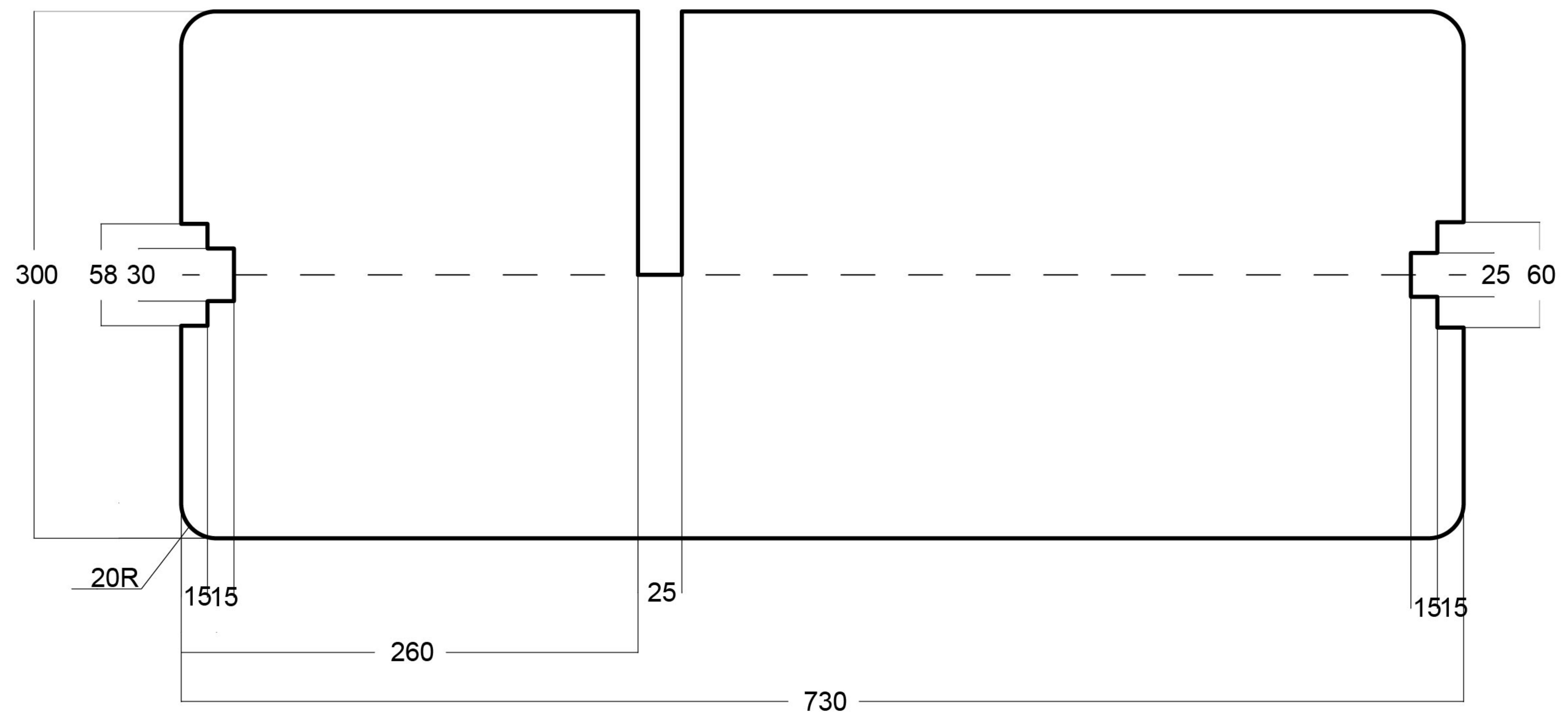

ASSEMBLY

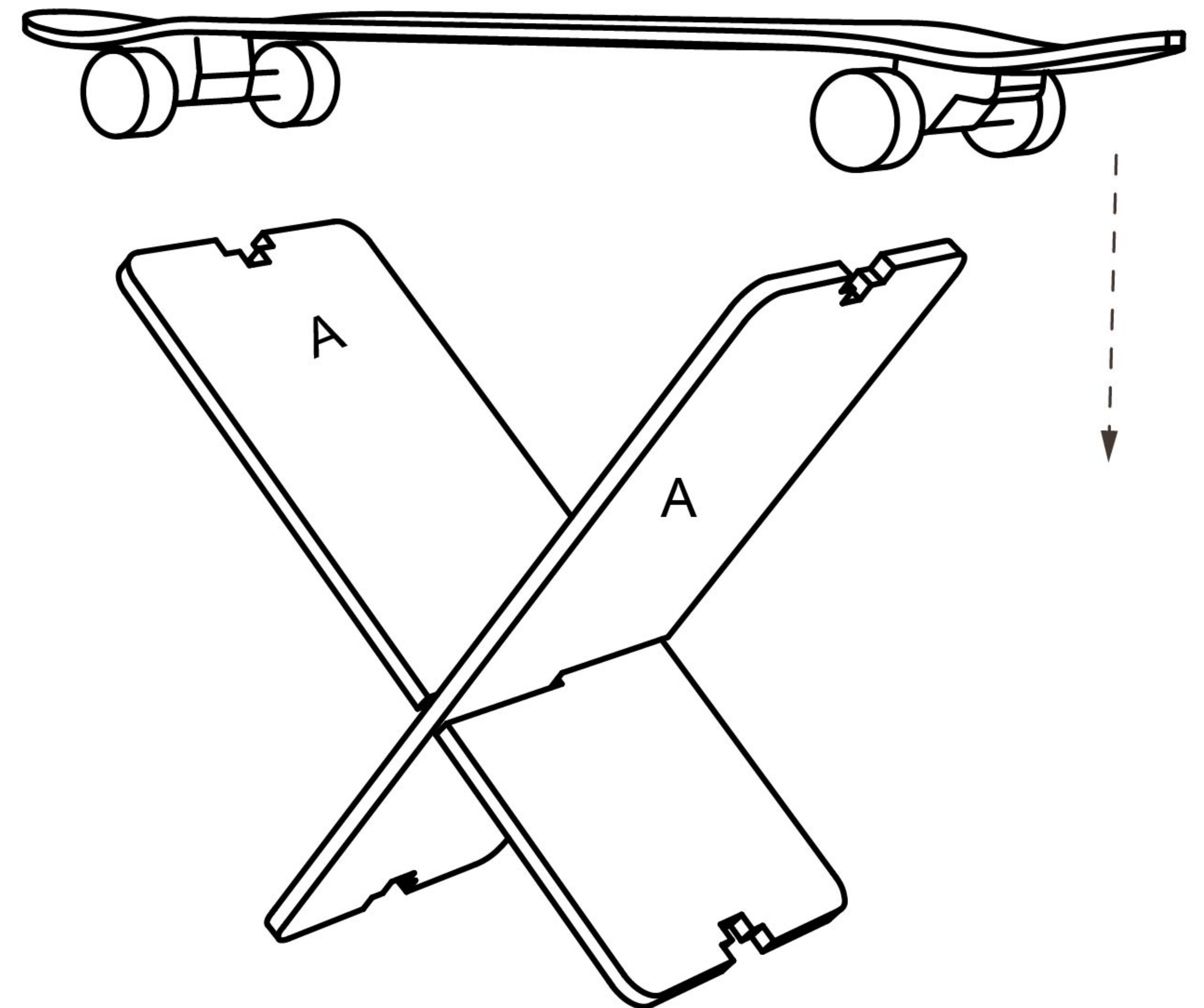
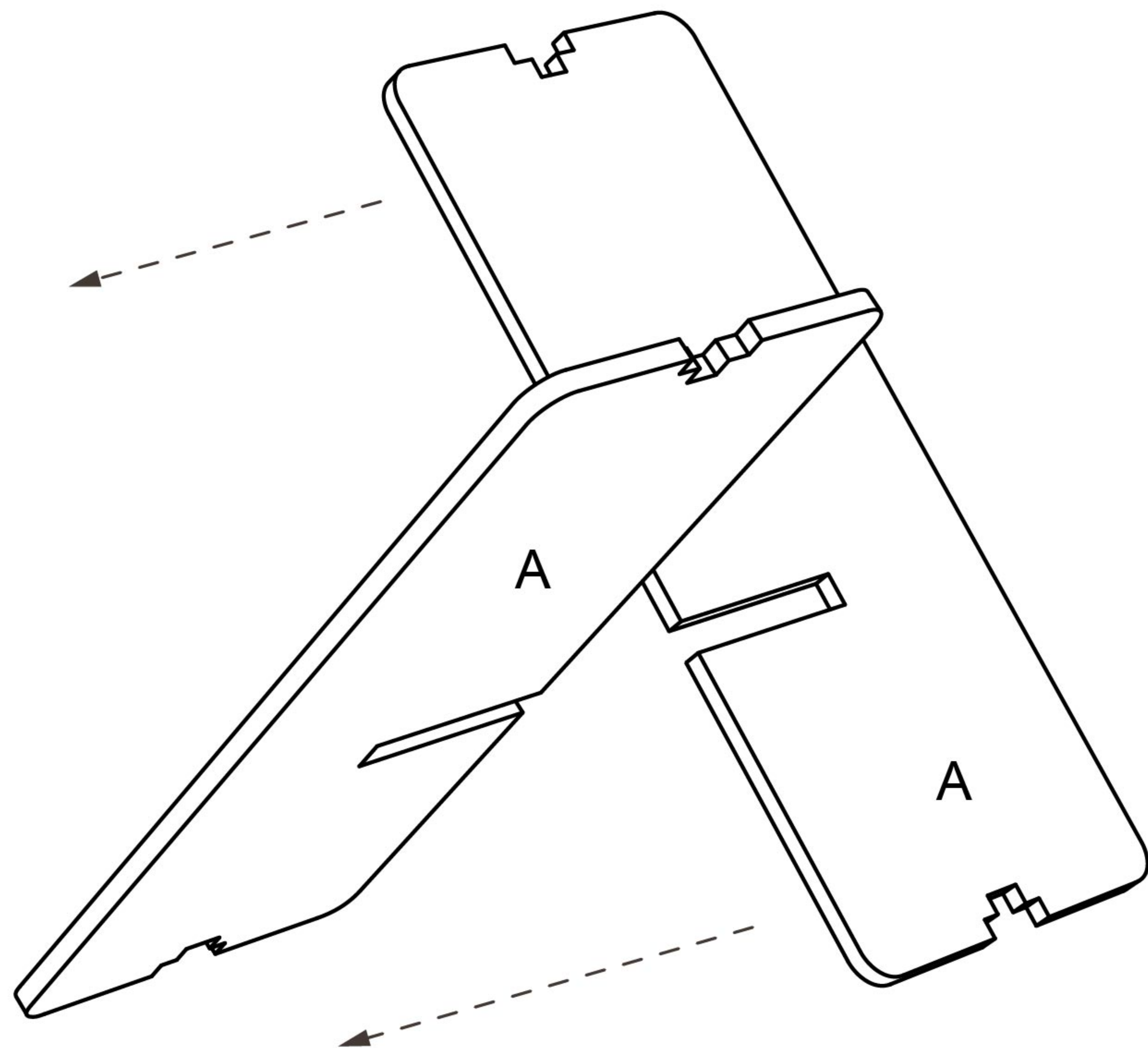
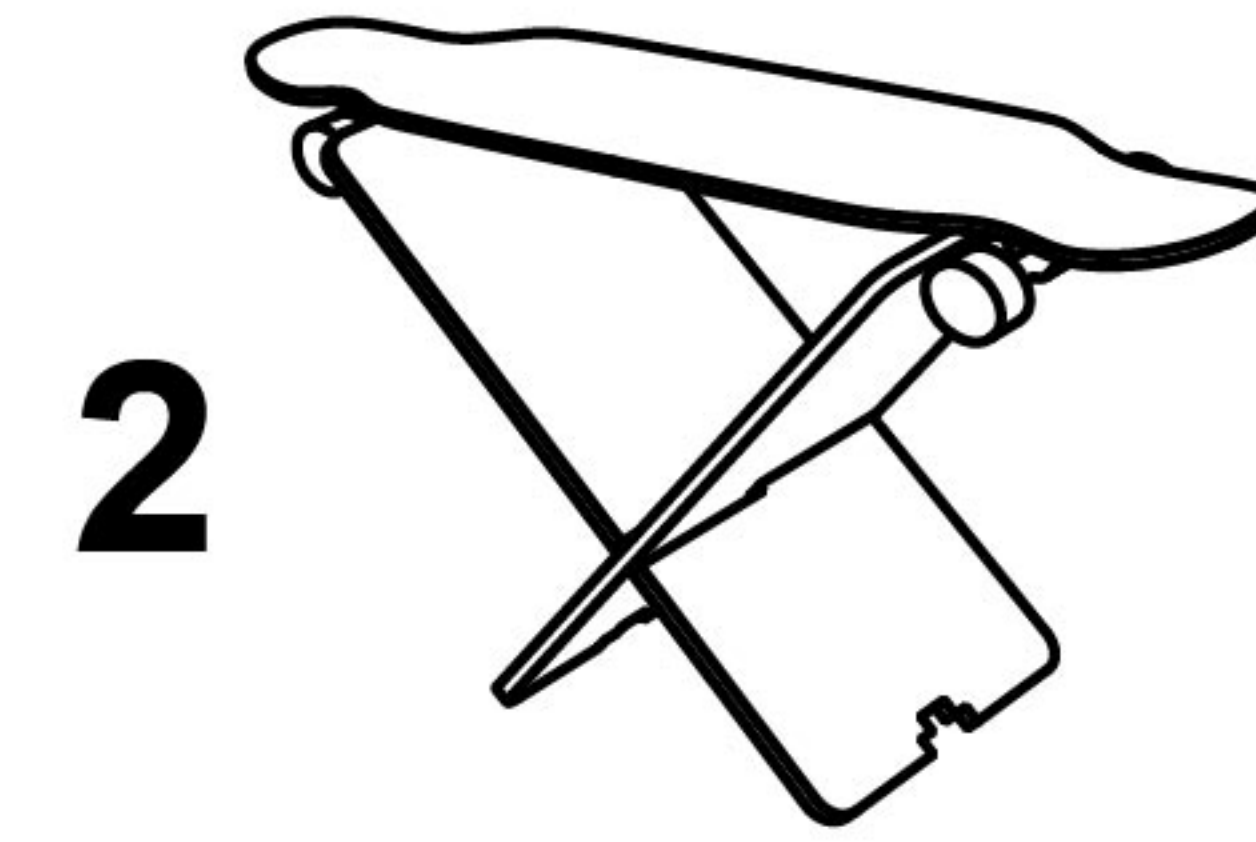
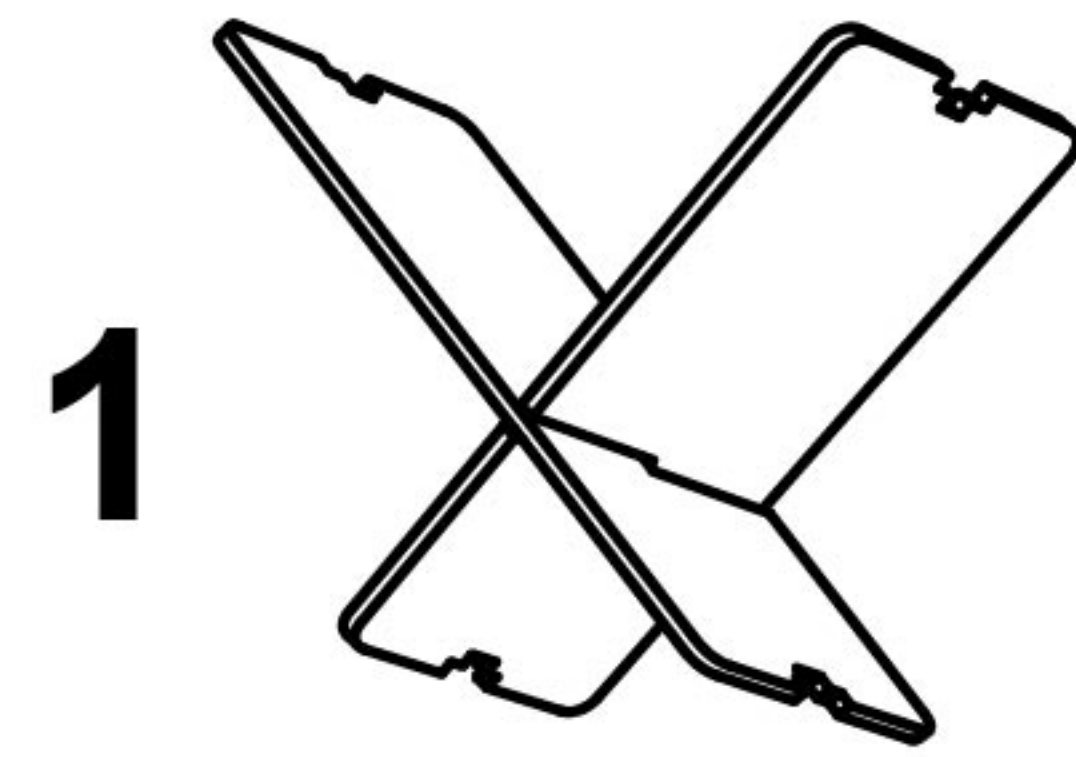

Finished!

OPTIONS

1

Short Skateboard

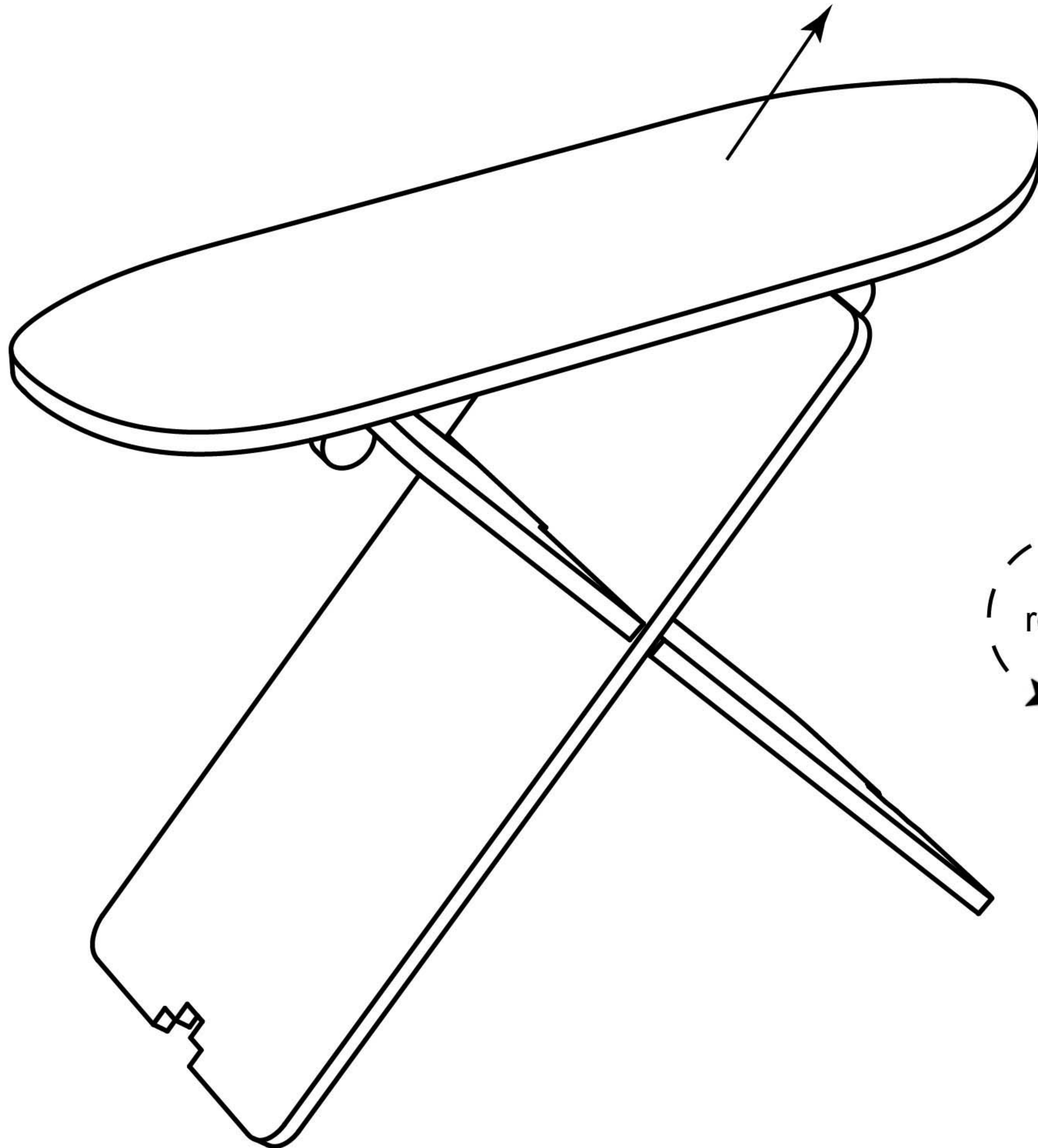

2

Long Skateboard

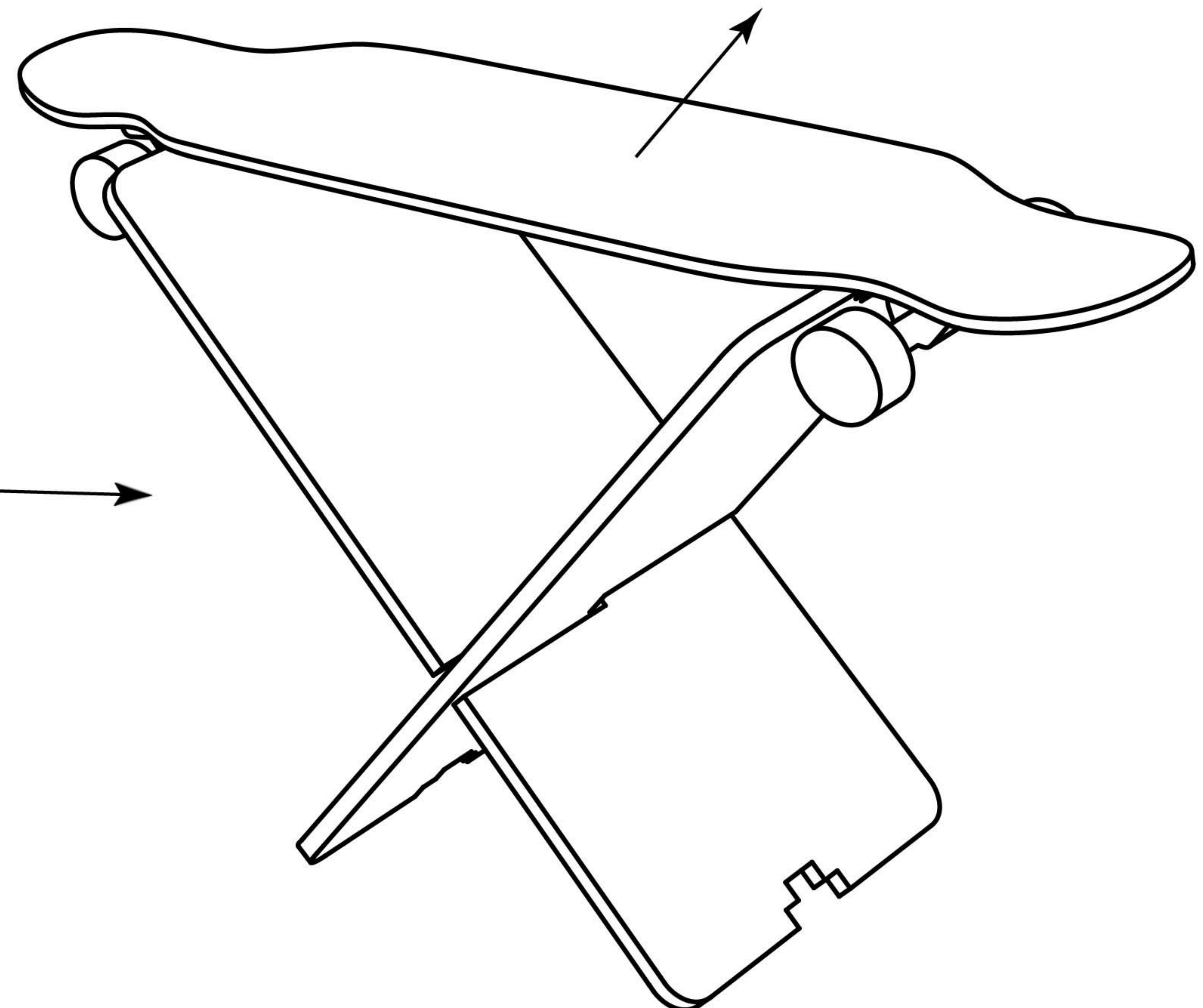

reverse



Finished!