

Fernando1 Stool

designer Ji Zemin
Yao Jiayi
Peng Jianfeng

materials Plybamboo

tools Hammer , CNC

units mm

update 2020/06/10

Guangdong University of Technology
Opendedesign Workshop

*If you have any problems when making this stool,
please contact us: 2686907771@qq.com

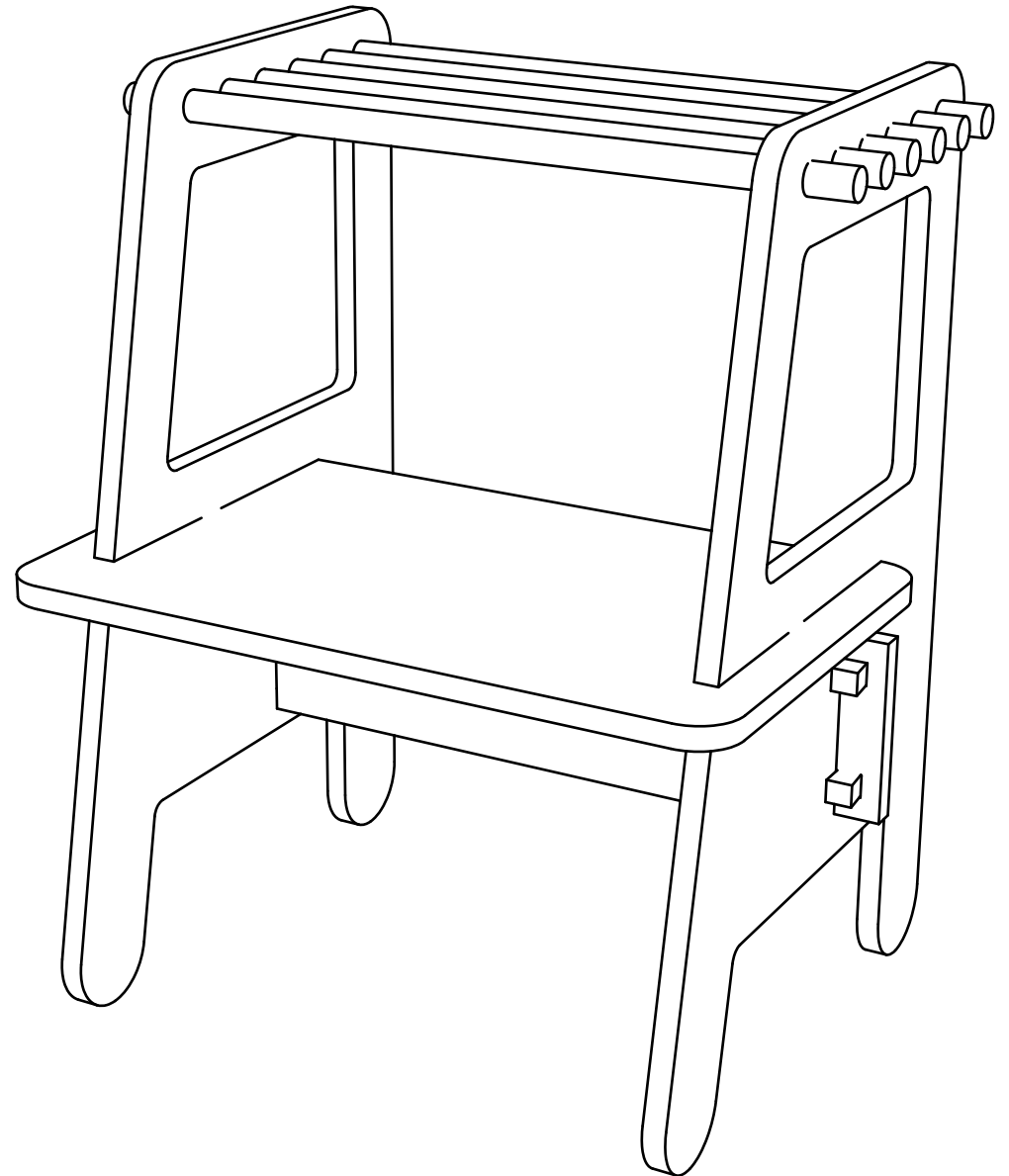

PARTS

15mm plybamboo

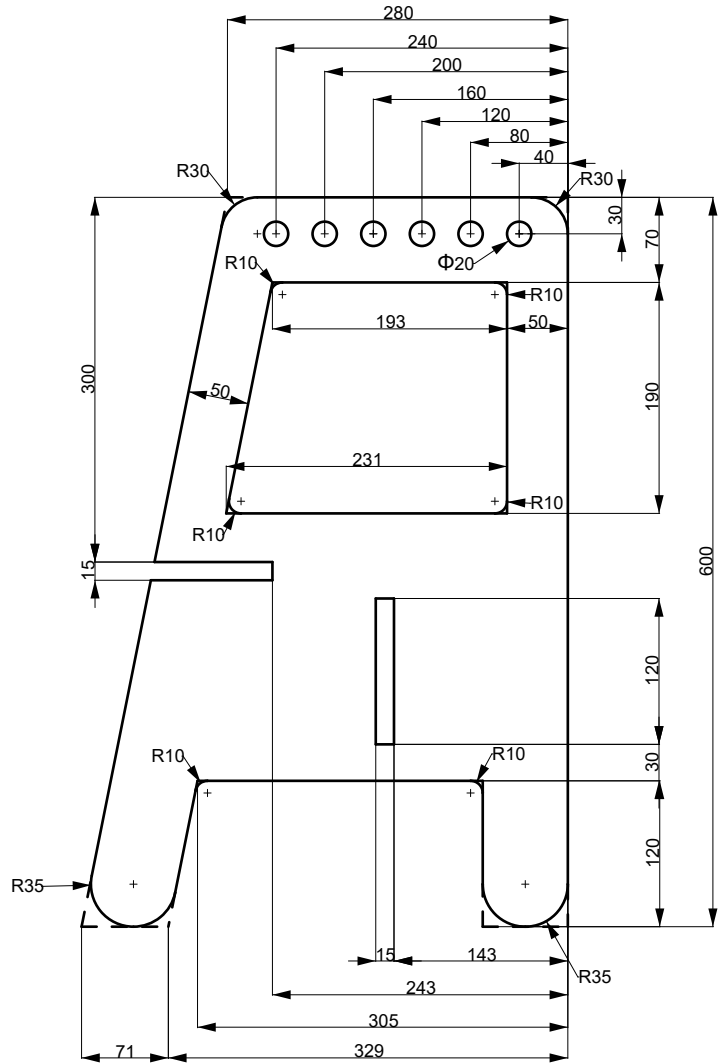

A (x2)

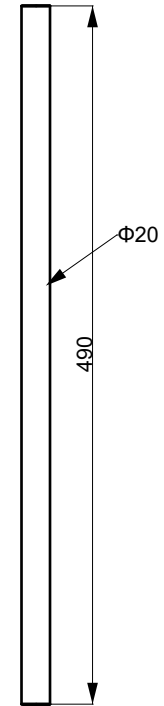

B (x6)

PARTS

15mm plybamboo

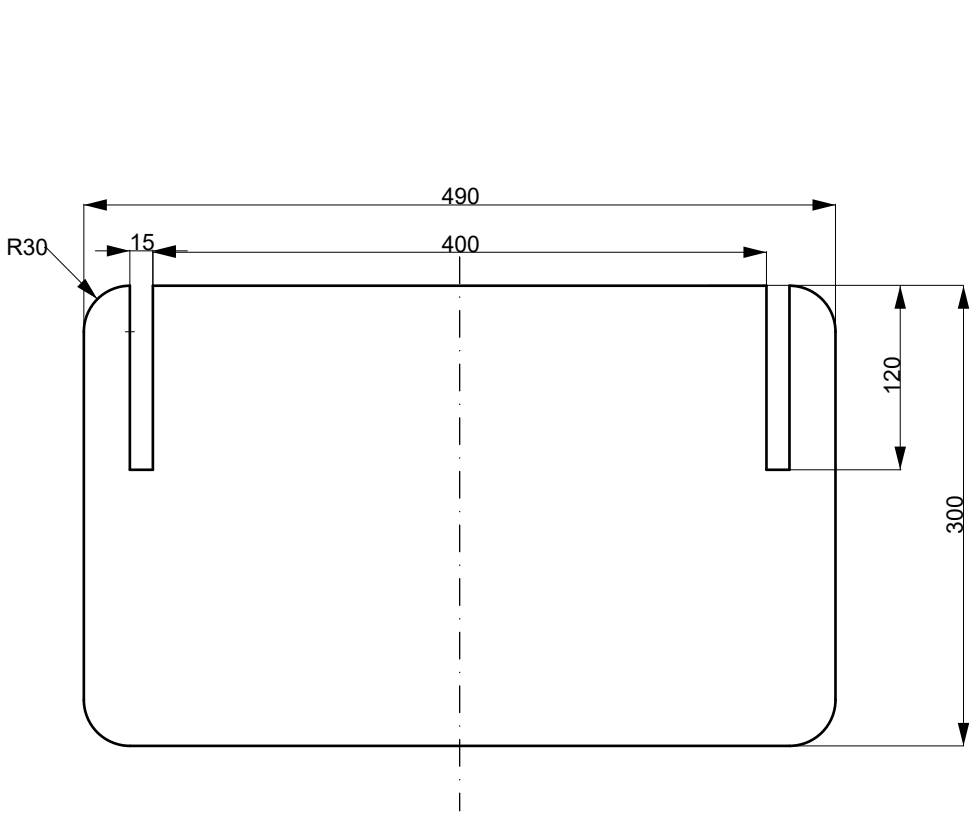

C (x1)

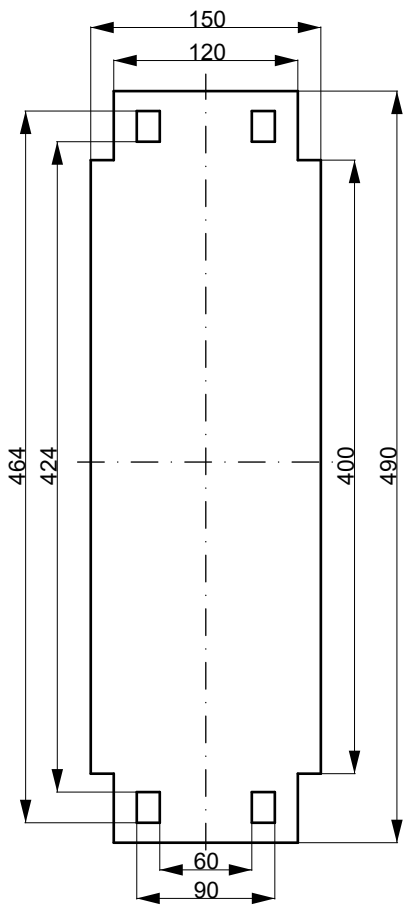

D (x1)

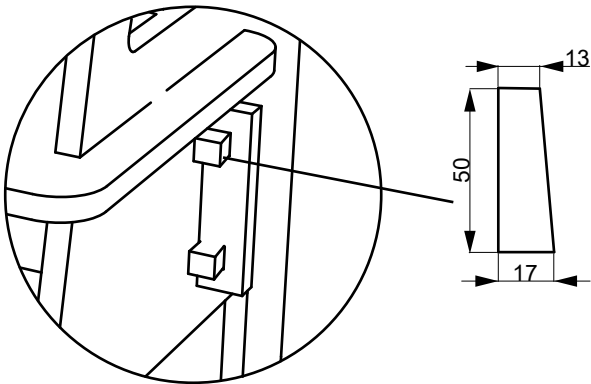

E (x4)

CNC NESTING

15mm plybamboo

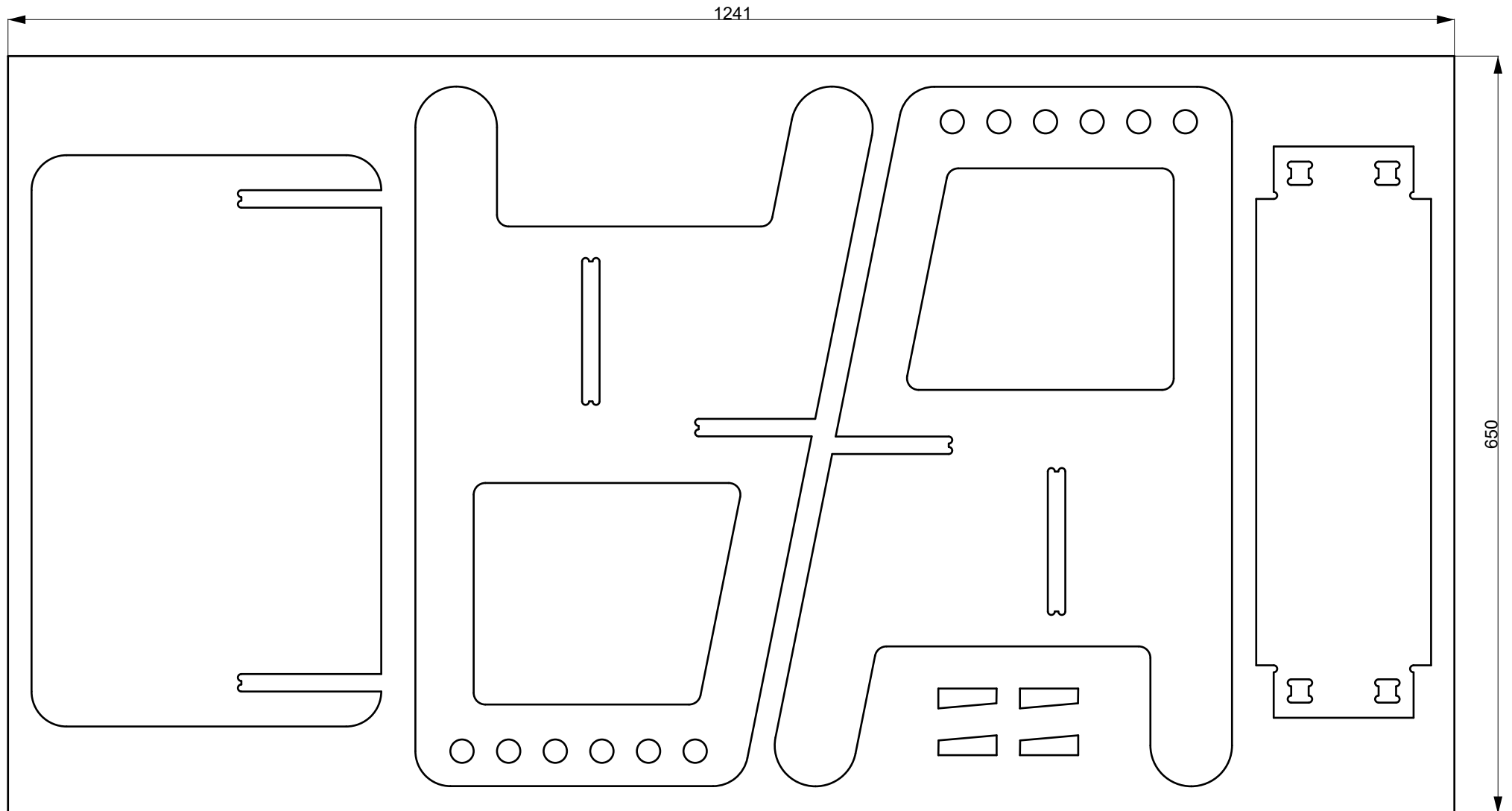

ASSEMBLY

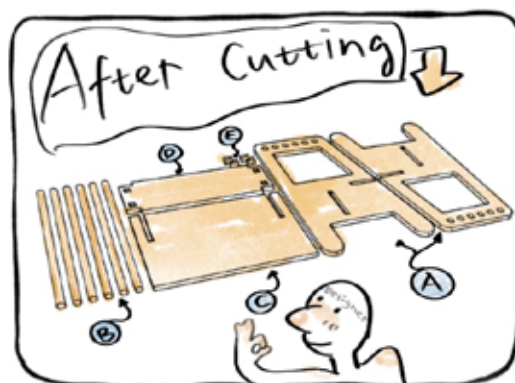

Handmake
How?



Side Plate Installation
(侧板安装)
+ stick

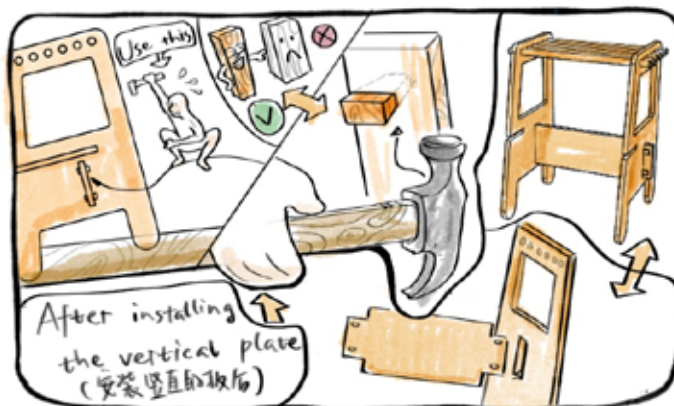

2
Install the Wedge
(安装楔子)

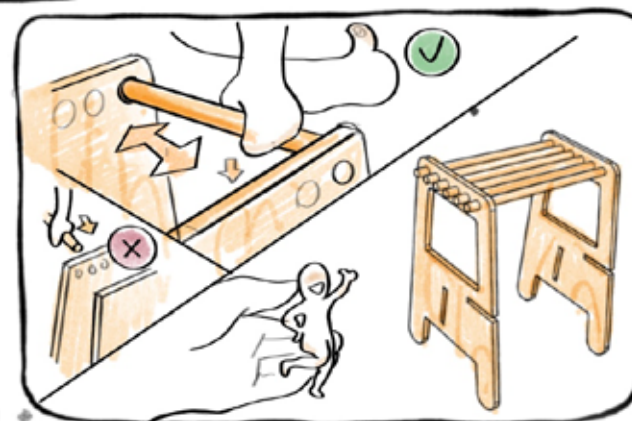

Insert crossboard
(插入横板)

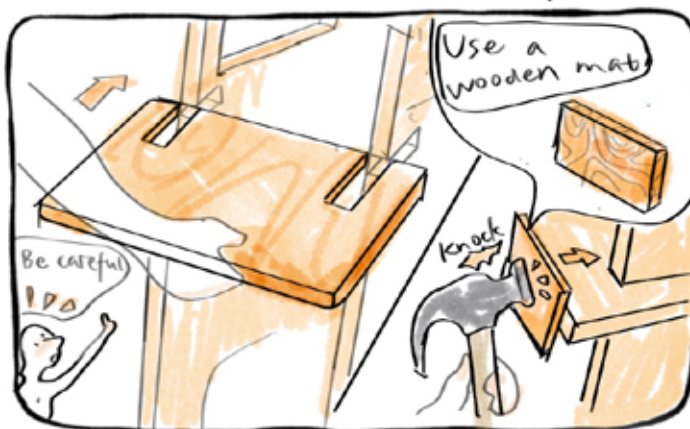

4
(敲紧)
Knock tight

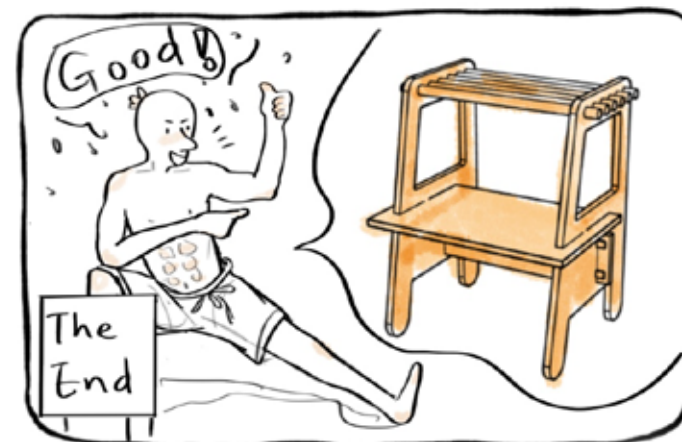

The End